

Made for
iPhone | iPad | iPod

ReSound GN

Quick guide to connectivity and the ReSound Smart 3D™ app





Content

Compatibility: Hearing aids and mobile devices4

Get started with your iPhone, iPad or iPod touch.....6

Pair with your ReSound Smart
 Hearing aids 6
 Stream sound 10
 Audio routing..... 12
 Control of your hearing aids built into your iPhone, iPad or iPod touch (triple click) 15

The ReSound Smart 3D app 19

Download and connect to your Apple or Android device..... 19
 ReSound Smart 3D app overview 22

Home screen

Program change and volume control24
 Quick buttons 28
 Sound Enhancer..... 30

Tinnitus Manager..... 34
 Favorites 36

Status

Connection and battery status 38

My ReSound

ReSound Assist..... 42
 Guiding tips 52
 Learn about the app 54
 Find my hearing aid..... 56

More

Additional app options 57

ReSound Smart 3D app for Apple Watch 58

Stream sound to your Android phone.... 62

Try more apps from ReSound 64

Compatible ReSound Smart Hearing aids

Here is a list of Smart Hearing aids from ReSound that work with the ReSound Smart 3D™ app. If you're in doubt, please ask your hearing care professional.

- ReSound LiNX 3D™
- ReSound ENZO 3D™
- ReSound LiNX Quattro™

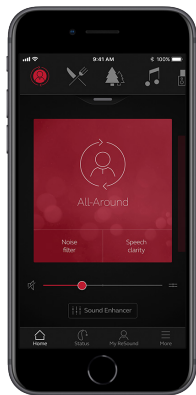

Compatible mobile devices

Apple: ReSound Smart Hearing aids support Made for Apple (MFi) functionality with iPhone 5 and later, iPad Pro, iPad Air and later, iPad mini and later, iPad (4th generation) and later, iPod touch (5th generation) and later using iOS 8.0 or later.

iOS 10 or later is required. Always install latest version of iOS for best performance. For use with Apple Watch, min. watchOS 3 is required. To use Apple Watch, you must also have the Smart 3D app installed and running on your IOS device.

Android: The ReSound Smart 3D app supports some of the most popular Android devices.

As we are continuously making more mobile devices compatible, please consult the ReSound Smart 3D app website for up-to-date compatibility information:

www.resound.com/compatibility.

Pair with your iPhone, iPad or iPod touch

How to pair your ReSound Smart Hearing aids to your iPhone, iPad or iPod touch

Check battery

Insert a fresh battery in your ReSound Smart Hearing aid.
Keep the battery door open so the hearing aid cannot power up.



Insert your rechargeable hearing aids in the charging case and ensure you have at least 1 green LED lit in the battery charge indicator.

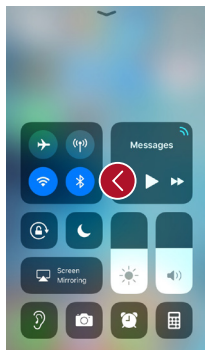

Turn on Bluetooth



Swipe upwards from the bottom of the screen to reveal the Control Center.

Tap the Bluetooth icon.

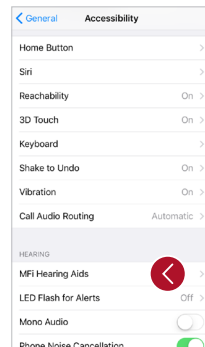
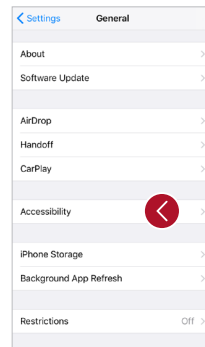
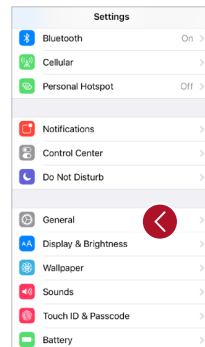

Detect hearing aids

Now that Bluetooth is activated, go to **Settings**, tap **General**, then **Accessibility**.

Close the battery door or remove the rechargeable hearing aids from the charger to power up your hearing aid so your iPhone, iPad, or iPod Touch can detect it. Then tap **MFI Hearing Aids**.

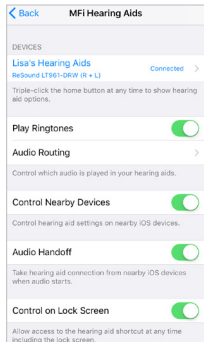
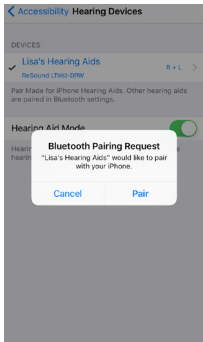

Make the connection

Tap on the name and model number of your hearing aid when it appears on the screen.

Tap Pair in the dialogue box. When pairing to two hearing aids, you will receive separate pairing requests.

The second request may take a few seconds to appear after starting the first pairing.

When it's connected, your hearing aid name color will change from black to blue and it will say "Connected" to the right.

To the right, use the small arrowhead to take you to additional hearing aid functionality.

Re-connecting your hearing aids to your iPhone, iPad or iPod touch

When you turn off your hearing aids or Apple device, they will no longer be connected. To connect them again, turn on your hearing aids by opening and closing the battery doors.

To reconnect your rechargeable hearing aids, insert them into the charging station, wait a few seconds and remove them again. Alternatively you can press and hold the button for minimum 5 seconds to turn off the hearings aids followed by another press and hold for minimum 5 seconds to turn them on.

The hearing aids will then automatically connect to your Apple device. You can also verify this connection by accessing the Accessibility shortcut (triple click the home button) and making sure that your hearing aids have been detected.

Pairing to more than one Apple device

You can pair up to five different Apple devices to your ReSound Smart Hearing aids, but you can only connect to one Apple device at a time.

To switch connection from one Apple device to another, swipe up from the bottom of your Apple device's screen and turn Bluetooth off.

Now you can activate Bluetooth on the device you want to connect to next.

Wait for authentication

When you tap on **Pair** in the dialogue box, your ReSound Smart Hearing aid and Apple device need time to authenticate the pairing. Either put your hearing aid on and wait for a series of 6 beeps followed by a ripple tone, or wait at least 120 seconds for authentication to finish. Please don't stream audio until authentication is complete.

Stream sound directly to your ReSound Smart Hearing aids

You can stream stereo audio, such as music, directly from your Apple device and apps to your hearing aids.

Control Center

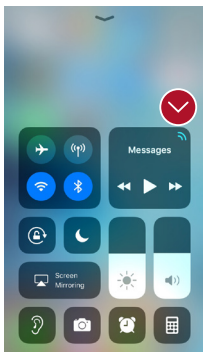

When your hearing aids are paired to the Apple device, the audio will automatically stream to your hearing aids.

To return to normal phone operation long press the streaming icon in the top right corner. A streaming menu will appear, select iPhone.

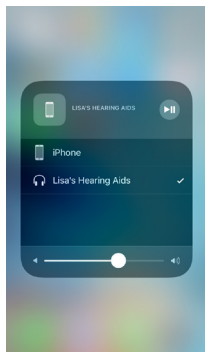

Phone and FaceTime calls

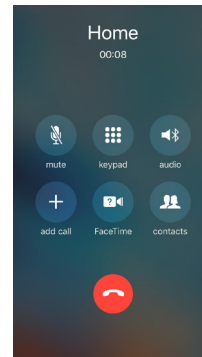

If a call comes in while you are streaming audio from your music player, answer it and the system will automatically turn down the music and switch to your phone conversation.

Once you end a call, the system will continue streaming music from where you left off.

i If I answer a call from Apple Watch, do I get the sound in my hearing aids?
If you get a call on your Apple Watch, scroll down on the digital crown and choose Answer on iPhone to get the sound in your hearing aids. Use the microphone on your iPhone to pick up your own voice.

Audio routing

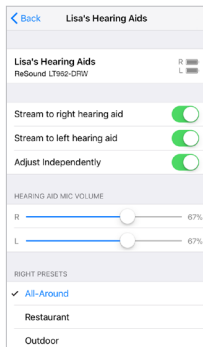

Hearing aid audio routing allows you to control how call and media audio will be directed.

Go to **Settings**, tap **General**, tap **Accessibility**, tap **MFi Hearing Aids**, tap **Audio Routing**.

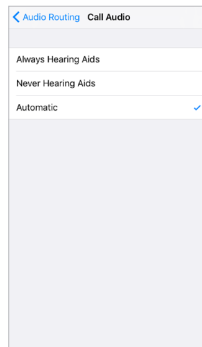

Select either: **Call Audio** (incoming phone calls) or **Media Audio** (for example streaming music).

Select how you wish to direct the audio input, for example **Always Hearing Aids**.

Setting to **Automatic** routing will route to a wired audio source if connected, then search and stream to either standard Bluetooth devices (for example CarPlay, A2DP Bluetooth devices) or hearing aids.





Control of your hearing aids built into your iPhone, iPad or iPod touch

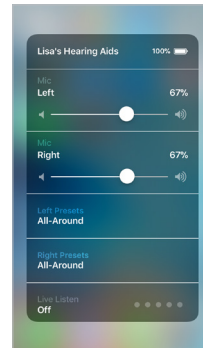

How to access basic hearing aid controls (triple click)

Triple click on the Home button to access the Accessibility shortcut with basic hearing aid controls.

You can for example adjust the left and right hearing aid volume and programs separately.

i Use the triple click or swipe up Control Center for fast access to hearing aid controls. Use the MFi Hearing Aids section in Settings for hearing aids adjustment related to the iPhone, iPad or iPod.

How to access basic hearing aid controls (swipe up)

When you swipe up the screen you see the Apple device Control Center. You can create a shortcut to hearing aid controls by going into **Settings**, then **Control Center**, then **Customize Controls**. Scroll down and find **Hearing Aids** and press the **+**. This will add a hearing aid shortcut to the control menu.



Control menu (swipe up)
Hearing Aid control shortcut.

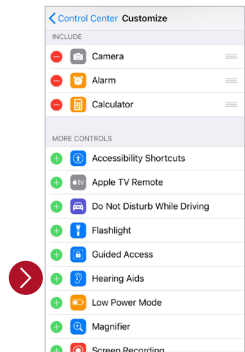

Customize Controls

How to make additional adjustments to your ReSound Smart Hearing aids (Settings)

You can also access a control section for your hearing aids in **Settings**. Go to **Settings**, **General**, **Accessibility**, and **MFi Hearing Aids**. Then tap on where it says **Connected**.

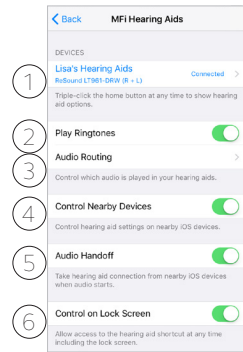

1. The name, model, and **connection** status of your hearing aids.
2. Enabling or disabling iPhone ring tones in your hearing aids.
3. Control which audio is played in your hearing aids.
4. + 5. Use these when you have paired the hearing aids to two iOS devices. You can manage the control of the hearing aids or the audio routing between iOS devices.
6. Enables you to have access to hearing aid controls when the iPhone /iPad is locked.



Smart control and personalization with the ReSound Smart 3D app



Download and install the ReSound Smart 3D app

The app can be downloaded for free on the App Store or Google Play by following these steps:

If you have an iPhone, iPad or iPod touch:

1. Go to the App Store
2. Search for “ReSound Smart 3D”
3. If you are on an iPad, change the search criteria in the top left-hand corner to **iPhone only**
4. Tap on **Get** and then **Install** to start downloading the app
5. Tap the ReSound Smart 3D app on your Home screen to start it up

If you have an Android device:

1. Go to the Play Store
2. Search for “ReSound Smart 3D”
3. Tap on Install, then Accept so the app can access certain features on your phone such as Bluetooth
4. When installation is complete, tap on Open to start up your ReSound Smart 3D app



Getting connected

The first time you open the app, we will take you through a few steps to get you connected. Start by accepting the Terms & Conditions and then continue with the flow shown here.

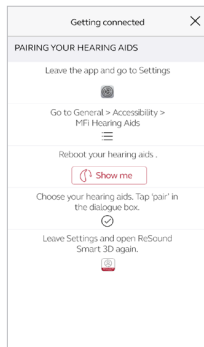

If you have an Apple device:
If you haven't already paired your Apple device with your hearing aids, please go to p. 6 and follow the steps to pair.

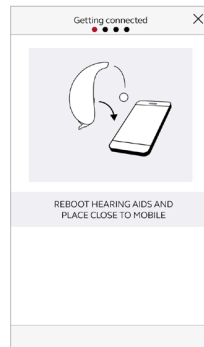

If you have an Android device:
Pair your Android device to your hearing aids:

Take off your hearing aids.

Reboot them (For hearing aids with single-use batteries, open and close the battery doors. For rechargeable hearing aids, insert the hearing aids in the charger, wait a few seconds and remove them again).

Place the hearing aids close to your mobile device.



Remember to allow push notifications and use of location-based services to make sure you're notified of messages from your hearing care professional and can enjoy all features of the app.

The ReSound Smart 3D app will guide you through the rest of the flow:

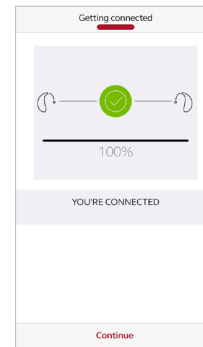
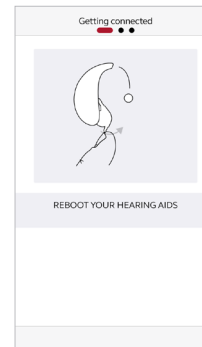
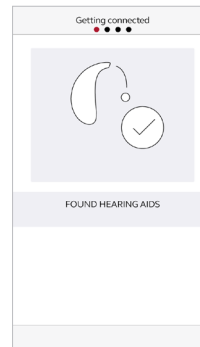

When you have paired in iOS Settings or done your first pairing on Android, the app will confirm that it has found the hearing aids.

Next step is to establish a secure connection between the app and your hearing aids. You do this by rebooting your hearing aids. This is the second time if you have an Android device.

When the green check mark appears, you're ready to go!

ReSound Smart 3D app overview

The ReSound Smart 3D app has four main screens, all accessible from the bottom navigation menu.

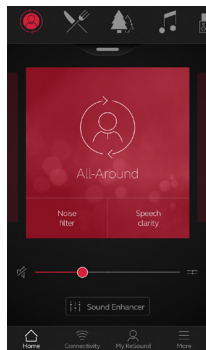

Home screen

The Home screen is your center for control. From here you have easy access to program and sound control.

You can always return to this screen by clicking the Home icon in the bottom menu.

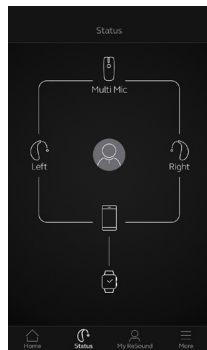

Status

The status screen will show you information about the connectivity between your mobile device, hearing aids, ReSound wireless accessories and Apple Watch.

Low-battery warnings will also be displayed here. If the connected hearing aids are rechargeable, a battery status indicator is shown for each hearing aid.

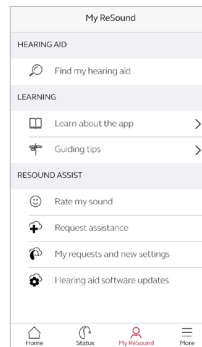

My ReSound

My ReSound is about you and your hearing aids.

This is where you, for example, find ReSound Assist.

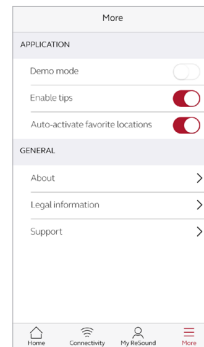

More

The More menu is where you adjust general app settings and find support and legal information.

🏠 Program change

The ReSound Smart 3D Home screen gives you direct access to change programs and Favorites in three convenient ways:

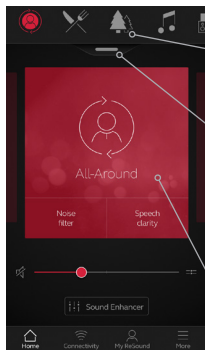

Top menu

Swipe to the left for all programs and Favorites.

Program overview

Pull down or tap on the handle below the top menu to view all programs and Favorites.

Quick swipe

Swipe on the red card to change programs. This view of each program also displays available Quick buttons.

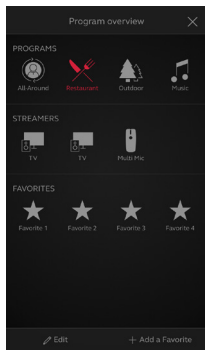

Program overview

When opening the program overview, you can see all your programs and Favorites. You can change and edit programs and also add Favorites.

🏠 Hearing aid volume control

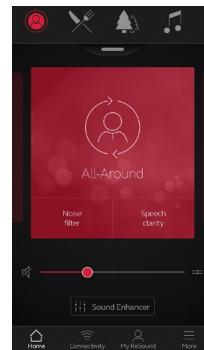

Volume control

Move the slider to adjust the volume in the hearing aids.

Mute

To instantly mute the sound coming from your hearing aids, tap the mute icon to the left of the volume slider.

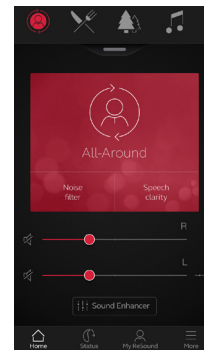

Independent volume control

To adjust volume for right and left hearing aids independently, tap the split icon to the right of the volume slider. Sliders for each hearing aid appear.

🏠 Streamer volume control

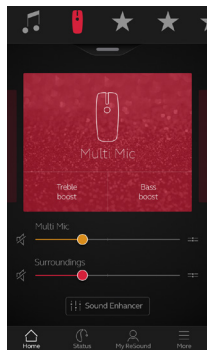

Streamer volume control

When a streamer program is selected, you can adjust the streaming volume separately with the orange volume slider.

Hearing aid volume

You can still adjust the volume of the hearing aids without affecting the volume of the audio you are streaming.

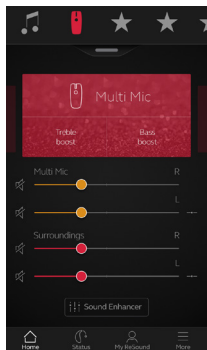

Independent streamer volume control

To adjust volume for right and left sides of the streamer device independently, tap the split icon to the right of the orange slider.



Can I mute all my devices?

You can mute your hearing aids or your streamer device independently by tapping on one of the mute icons to the left of the volume sliders. To unmute, re-tap the mute icon or tap on the card in the middle of the screen.

🏠 Mix-in streaming volume control



For ReSound Linx Quattro and later hearing aids with mixed-in streaming, phone call or audio streaming volume is controlled by the volume controls on the device. To quickly optimize the volume settings for either streaming signal or surroundings, use the quick buttons.

Quick buttons

Each program has individual Quick buttons. Quick buttons are shortcuts to instant sound optimizations when you need them.

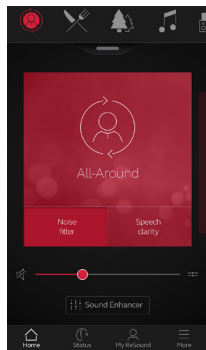

Quick buttons are displayed on the red card just below the program name.

Tapping a Quick button will activate it until you tap it again to deactivate it.

Quick buttons activate predefined combinations of sound enhancer settings. An activated quick button will therefore also be deactivated by adjusting or resetting settings in the sound enhancer menu.



Sound Enhancer: Personalize your sound

Sound Enhancer lets you fine-tune bass, middle and treble, Noise reduction, Speech focus and Wind noise reduction.

Availability of Sound Enhancer varies per hearing aid model and program depending on your fitting.

Noise reduction, Speech focus and Wind noise reduction are only available for top price-point hearing aid models. Bass, middle and treble is always available.

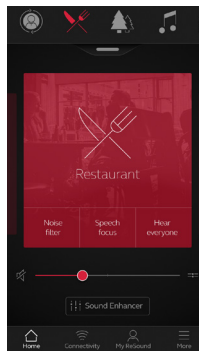

Access Sound Enhancer from the bottom of the Home screen.

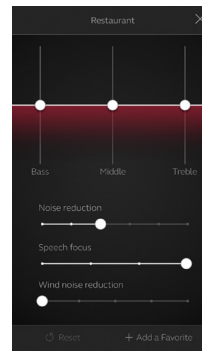

A view of Sound Enhancer with all possible features shown.

Move the sliders to interact with each feature and make adjustments.

When you interact with one of the features, the screen will focus on that feature alone. See next page.

Tap Reset to return to fitted settings.

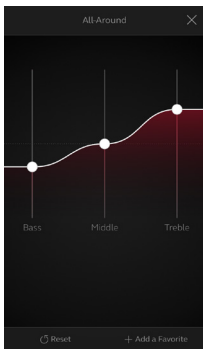

Bass, middle and treble

Increase or decrease bass, middle and treble frequencies.

Adjustments are also applied to streamed sound.

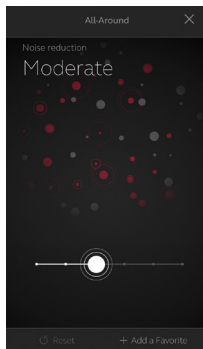

Noise reduction

Adjust the level of noise reduction from full awareness of surroundings to focused hearing.

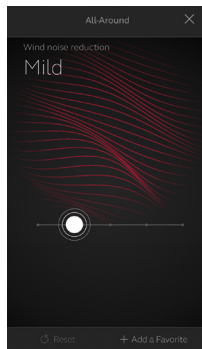

Wind noise reduction

Adjust and reduce wind noise for maximum listening comfort in windy situations.

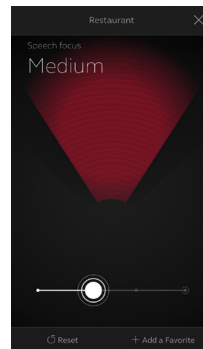

Speech focus

Choose exactly what to listen to by adjusting the focus of the beam.

When the hearing aids are set to automatic focus, adjusting Speech focus will switch them to manual setting. To return to automatic use, slide to the far right.

i Can I save my settings?

When you find settings you like, you can save them as Favorites. If you don't save them, the adjustments will remain until you click the reset button or reboot your hearing aids (opening and closing the battery doors).

i Optimize Speech focus

When adjusting Speech Focus, also try the Noise reduction for maximum effect.

Tinnitus Manager

The Tinnitus Manager is available for you in the app if the Tinnitus Sound Generator (TSG) has been enabled in one or more of your fitted programs by your hearing care professional.

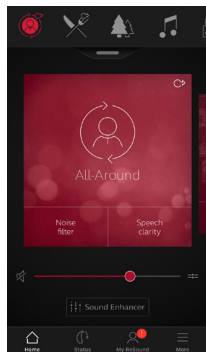

A small icon will appear in the top right corner on programs if you have the TSG fitted. If you go to the Sound Enhancer menu from one of those programs, you will see the Tinnitus Manager available.

What you will have access to in the app

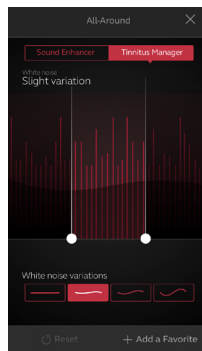

If you have a program fit with white noise

Pitch

Adjust the frequency shaping (Pitch) by moving the two sliders left and right.

Sound variation

Adjust the variation of the white noise sound input by tapping the buttons towards the bottom.

Tap Reset to return to fitted settings.

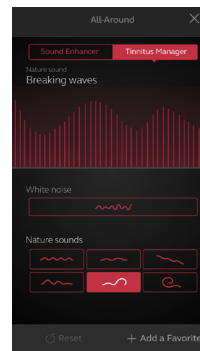

If you have a program fit with a Nature Sound

Choose between one of the six Nature Sounds in the hearing aid.

You can also activate the white noise sound input and adjust the Pitch.



Can I save my settings?

When you find settings you like, you can save them as Favorites. If you don't save them, the adjustments will remain until you reboot your hearing aids (opening and closing the battery doors).

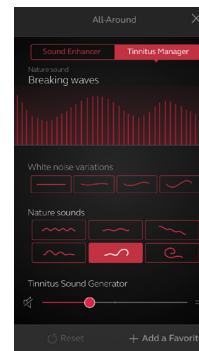

If you have a ReSound LiNX Quattro

Choose between one of the 6 nature sounds or 4 white noise variations. Adjust the white noise pitch by moving the two sliders.

Adjust the volume of the TSG signal separately from the hearing aid volume by moving the TSG volume control slider.

🏠 Favorites

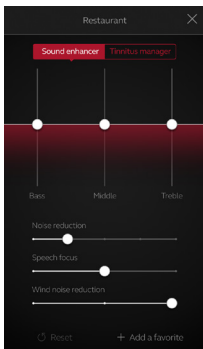

Add a Favorite

You can save your preferred sound settings as a Favorite.

Tap Add a Favorite at the bottom of the Sound Enhancer or the program overview.

Changes made to sound settings can be saved as a new Favorite or to update an existing Favorite.

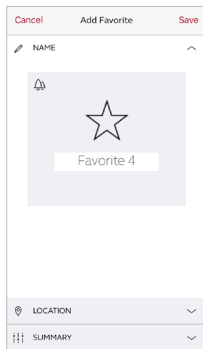

Name

Start by naming your Favorite.



What are the settings of my Favorite?

To view the settings of your Favorite, tap Summary at the bottom of the screen. You can do this when you add the Favorite or if you enter Edit mode.

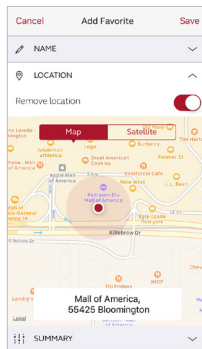

Location

You can also choose to add a location to a Favorite.

You can choose to have your hearing aids automatically change to the Favorite when you enter that location.

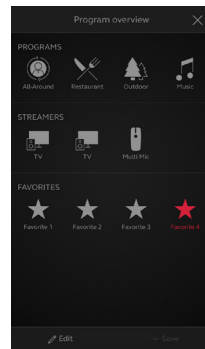

Favorite overview

When you have saved your Favorite, it will be added to the program navigation menus.

To edit or delete an active Favorite, tap Edit at the bottom of the program overview. Then tap the Favorite. Edit name, location or tap

Delete at the bottom of the screen.

To delete all your Favorites, simply tap Delete all Favorites at the bottom of the program overview after you tap Edit.

Status

Connection and battery status

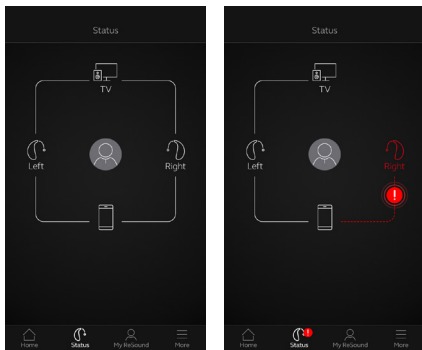

Connection status

Shows the connection status between your hearing aids, streamer device and mobile device. If you have an Apple Watch connected, that will be shown too.

If you see a red line with an exclamation mark, it means the connection is missing or broken.

i What if I lose a connection?

When a connection is lost, tap the exclamation mark to receive guidance on how to re-establish the connection. It is a good idea to check that your hearing aids are powered on, are within phone range and have enough battery charge. You can also open and close the battery door if connection is not re-established straight away.

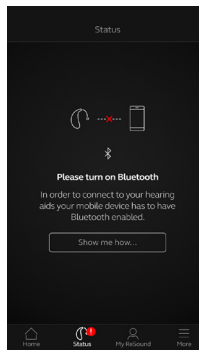

Bluetooth off

Bluetooth must always be on to use the app with the hearing aids. If it is turned off, the app will guide you to turn it on.

i What if I lose a connection?

On your rechargeable hearing aids, you can press and hold the button for 5 seconds to turn them off and then press and hold for 5 seconds to turn them on again. If you continue to experience connection issues on MFi devices, try enabling the setting 'Optimize MFi connection' in the More menu.

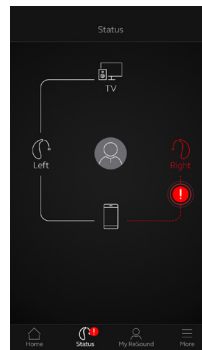

Low-battery warning

If the battery on one or both of your hearing aids is running low, a red battery will show next to the hearing aid(s).

Rechargeable hearing aid status

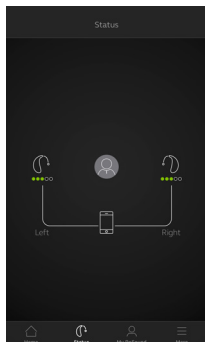

If the connected hearing aids are rechargeable, a battery status indicator will show the current state of charge for each hearing aid.

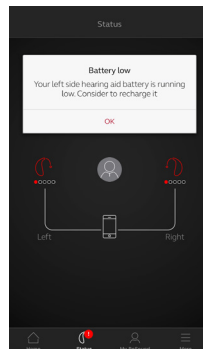
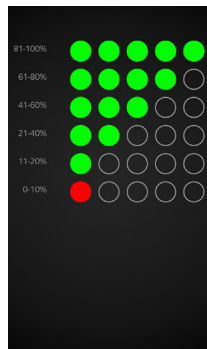

Battery charge levels

The battery indicator is a scale of 1 to 5 with each dot corresponding to a battery charge interval. Once the battery charge level reaches below 10%, a red exclamation mark and a battery charge notification will indicate it is time to charge the hearing aid

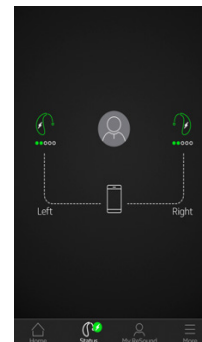

Hearing aids charging

Once your rechargeable hearing aids are placed in the charger, a green lightning on the status screen will show the hearing aids are in charging state and the connection will be shown as a dotted line. While charging, the battery indicator will show the current state of charge.



ReSound Assist: Hearing care wherever you are

If you need more fine-tuning than the ReSound Smart 3D app offers, you can use ReSound Assist for direct access to help from your hearing care professional. With ReSound Assist, you can send a request for assistance with your hearing aid settings and you can receive new settings in the app, ready to install on your hearing aids.

Please note that access to ReSound Assist requires the following:

- Availability in your market
- One or more of its features has been enabled for you by your hearing care professional

Request assistance

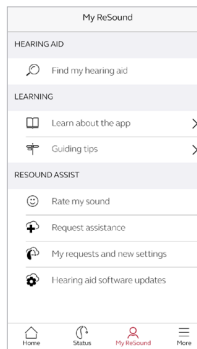

My ReSound

Go to My ReSound in the bottom menu to find ReSound Assist. Tap 'Request assistance' to reach out to your hearing care professional. Then just follow the flow, as also shown in the following steps.

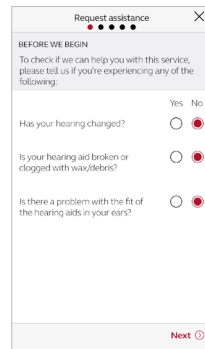

Before we begin

We ask you a few questions about your hearing and your hearing aid before we start. This is to check if this service to fine-tune your hearing aid settings can help you.

It's important that you don't think that your

hearing might have changed, for example got worse. If you can answer 'No' to all questions, tap 'Next' to continue.

 Try out your direct fine-tuning options in the ReSound Smart 3D app first. Use ReSound Assist if you're experiencing recurring problems or need more fine-tuning than you can find in the app.

The steps shown for ReSound Assist in this guide are examples from the flow in the ReSound Smart 3D app.

Defining your problem and sending

In the following steps, simply mark your responses as they match your experience. The more input you give, the better your hearing care professional can help you.

Request assistance

DEFINE YOUR PROBLEM

Please mark the problem(s) you're experiencing. You can add your own description on the last page:

- Too loud
- Too soft
- Muffled, unclear
- Extra noise, whistling, static
- Too sharp, tinny or shrill
- The sound fluctuates or cuts in and out
- Other

Previous Next

Request assistance

HOW SEVERE IS THE PROBLEM?

Slightly annoying Annoying Hearing aid unusable

WHICH SIDE IS THE PROBLEM ON?

Left Both Right

WHICH PROGRAM(S)?

All programs

All-Around Restaurant Outdoor

Music TV1 iPhone

Previous Next

Filling in your information

On the first step shown here, you can choose 'Other' if none of the options available describes your experience. You can add a personal message in the last step to describe it yourself.

On the second, tell your hearing care professional how severe you find the problem, which ear it's on, and in which programs you experience it.



Fill in a response on every screen in order to proceed.



Request assistance

SUMMARY

- Too loud
- Extra noise, whistling, static
- In certain environments: Noise
- Annoying
- Ear side: Both
- Restaurant
- Music

REQUEST TITLE

Too loud

PERSONAL MESSAGE

When I'm out eating at restaurants, I often experience...

Previous Send request

Send request

Tap 'Send request' when you're ready. Make sure your hearing aids are connected to the app when you send, as your current hearing aid settings are included in the request. Also, make sure your mobile device has a network connection.



After you send the request, you will receive a confirmation from your hearing care professional. The confirmation will tell you when you can expect to receive new settings or a message in response.

My requests and new settings

Active Closed

Hearing aid settings

TOO SOFT PITCH
Ready to install
10 Jun 2017
Install

My requests

TOO LOUD
Sent
08 Jun 2017
Read

Restore to previous settings

Viewing requests

To view your previous requests and responses from your hearing care professional, go to My ReSound and tap 'My requests and new settings'. Lists of active and closed requests will be accessible. Tap one to see more.

Receiving new hearing aid settings

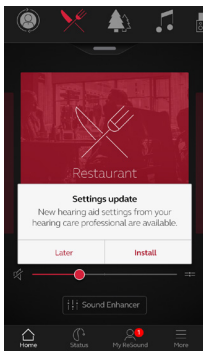

Notification

When your hearing care professional sends you new hearing aid settings, you will receive a notification either on your mobile device or directly in the app. Tap 'Install' to do the installation now, or 'Later' to do it when it's more convenient for you.

If you tap 'Later', a notification badge on My ReSound in the menu will remind you to do it. Go to that menu to install.

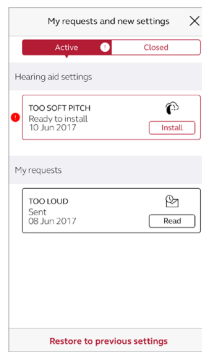

Starting the installation

New hearing aid settings are placed as the first listing on the screen. Tap 'Install' to begin. The installation takes about 1 minute.

Your hearing care professional can include a message for you, to explain what is included in the new settings.

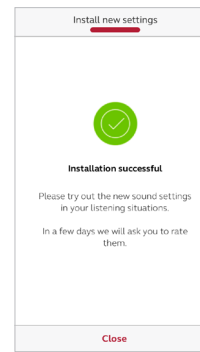
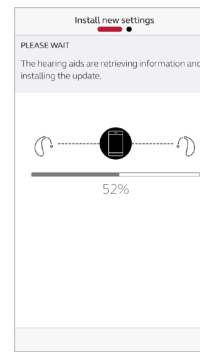
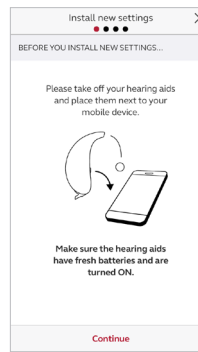

Installing new hearing aid settings

In the following steps, the app guides you through the flow. Note that the hearing aids will turn off sound during the installation.

You can follow the progress of the installation. The green check mark tells you when it's complete. Tap 'Close' and try out your new hearing aid settings!

i If, for some reason, you want to restore your previous settings after installing the new ones, go to My ReSound and tap 'My requests and new settings'. The option to restore previous settings is available at the bottom and you just follow the flow.

Rate my sound

When you have a new fitting or fine-tuning of your hearing aids, the app will ask you to rate your sound settings after a few days. Your rating will be sent directly to your hearing care professional. If you're not satisfied with your sound settings, your hearing care professional can then adjust them for you.

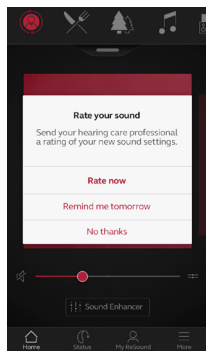

Notification

You will receive a notification to rate your sound settings. It will show either on your mobile device, or directly in the app.

If you tap 'Remind me tomorrow', you will receive another notification in a day. You

can also go to My ReSound to rate under 'Rate my sound'.

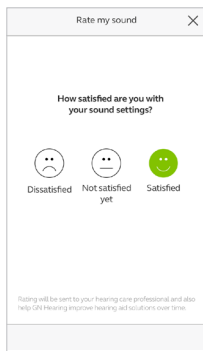

Rating

Rate your sound settings with one of these three options:

- Satisfied
- Not satisfied yet
- Dissatisfied

You can rate your sound settings once.

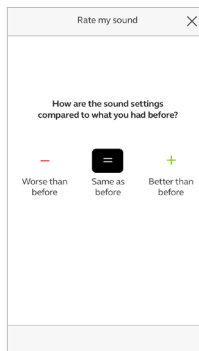

Comparison

If your sound settings have been fine-tuned, the app will ask you to compare the new sound settings with your previous sound settings. Are they:

- Better than before
- Same as before
- Worse than before

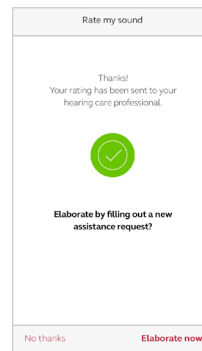

Sending a new request

If you rated 'Dissatisfied' or 'Not satisfied yet', the app will ask you to elaborate by filling out an Assistance request (see separate chapter).

Elaborating on your experience greatly helps your hearing care professional to adjust your sound settings.

Receiving new hearing aid software

ReSound Assist also offers updates to your hearing aid software. Sometimes it's beneficial to update the software for improved performance, and you can now do it directly in the ReSound Smart 3D app.

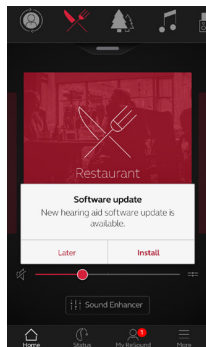

Notification

When a software update is ready for your hearing aids, you will receive a notification either on your mobile device or directly in the app. Tap 'Install' to do the installation now, or 'Later' to do it when it's more convenient for you.

If you tap 'Later', a notification badge on My ReSound in the menu will remind you to do it. Go to that menu to install.

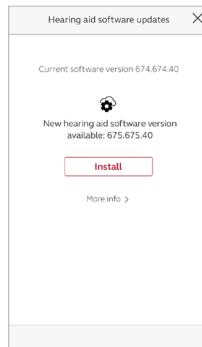

Information

You will see which new software version is available for your hearing aids. A message will also be included, to explain what is in the update.

Note that the hearing aids will turn off sound during the installation.

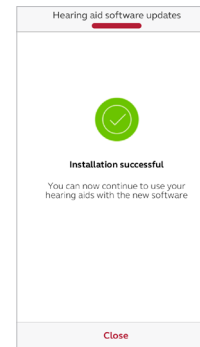
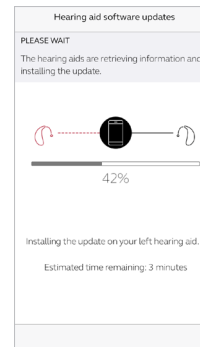
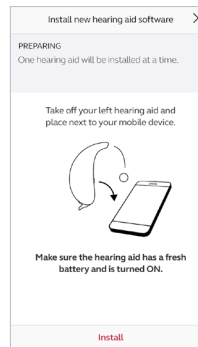

Installing new hearing aid software

In the following steps, the app guides you through the flow. Please keep all devices close during the installation.

You can follow the progress throughout the installation. The green check mark tells you when the installation is complete. Tap 'Close' and you're ready to go!

i Do the installation of new hearing aid software when it's convenient for you. It takes about **5 minutes** per hearing aid, so it's important that you have the time. It's recommended to complete the installation once started.



Guiding tips

The ReSound Smart 3D app offers Guiding tips to help you get a better hearing experience. The Guiding tips pop up in the app during the first weeks of wearing your hearing aids and using the app. It's your choice if you want to receive Guiding tips – the app will ask you.

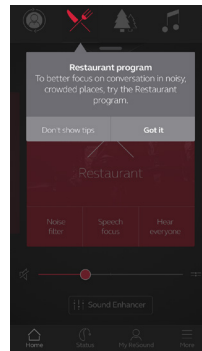

Experienced hearing aid user

If you are an experienced hearing aid user, you will receive the Guiding tips on use of the app.

These tips will highlight different features in the app, if you haven't already used them.

Tap 'Got it' when you've read the tip. Tap 'Don't show tips' if you don't want any more Guiding tips to be shown.

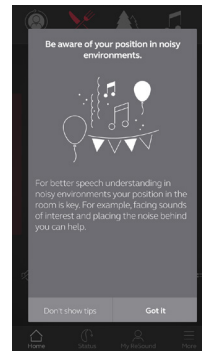

New hearing aid user

If you are new to wearing hearing aids, or would just like to know more, you will receive Guiding tips for use of the app as well as general hearing guidance.

Tips on general hearing guidance include advice about getting used to wearing hearing aids and what you can do to achieve the best result.

Learn about the app

To learn even more about how the app works, go to 'Learn about the app' in the My ReSound menu. Explore the app, and what you can do, section by section.

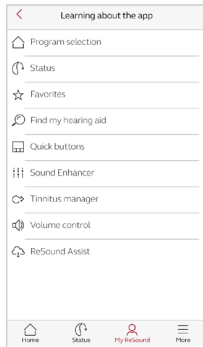

Overview

The full list of items that you can explore to learn more about the app.

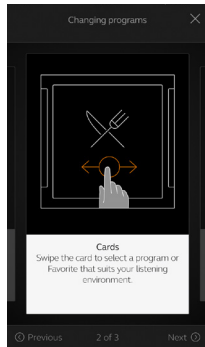

Example: Changing programs

Learn how to change programs by swiping on the cards on the Home screen.



Find my hearing aid

If you have lost your hearing aids, go to My ReSound and tap on 'Find my hearing aid'. The app can help you locate them.

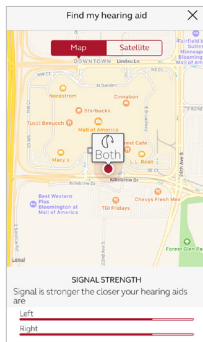

Last location

The map will show where the hearing aids were last seen connected to the app. Tap the hearing aids to see address and time they were last seen. You can switch between Map and Satellite views.

If you have chosen to 'optimize MFi connection' in the more menu the app will only track the location of your hearing aids when the app is used.

If the 'Optimize MFi connection' is off, the app will also track location when the app is running in the background.

Search nearby

If the app detects the hearing aids nearby, it will show you if you are getting closer or farther away from your hearing aids. Look for the indication on the red bars at the bottom of the screen.

Hearing aids must be On to use this feature.

More

Additional app options

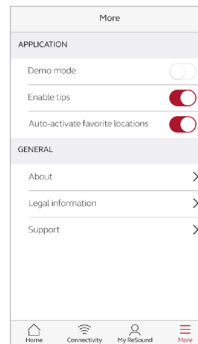

Application: App customization

1. Demo mode: view the app without being connected to hearing aids.
2. Guiding tips: turn on or off.
3. Auto-activation of favorite locations: Choose if you want your Favorites to automatically change to the locations you saved.

General info

1. About: Read about the app and the ReSound brand
2. Legal information: See next screen
3. Support: Find tips and links for further support

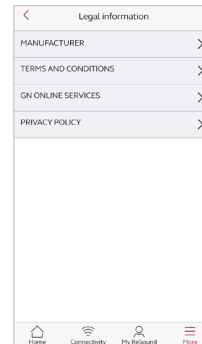

Legal information

1. Information about legal manufacturer, app version number etc.
2. Terms and conditions for use of the app.
3. GN Online Services: Review, give or withdraw consent to data-processing.
4. Privacy policy.

ReSound Smart 3D app for Apple Watch

Control the smartest hearing aids straight from your wrist

What you need

The ReSound Smart 3D app must be installed on your iPhone. Please follow the instructions found in the Apple Watch companion app on your iPhone.



How to get the ReSound Smart 3D app on your Apple Watch

How to get the app on Apple Watch

- Open the Apple Watch app on your iPhone.
- Scroll down until you see 'Smart 3D' in your list of apps. Tap it.
- Enable 'Show App on Apple Watch'.
- You will see the ReSound Smart 3D app become available on your Apple Watch.

More menu

- When your Apple Watch and iPhone are paired, further Watch settings are accessible from the More menu.
- Sound Enhancer features should be specifically enabled in this menu in order to see them on Watch.

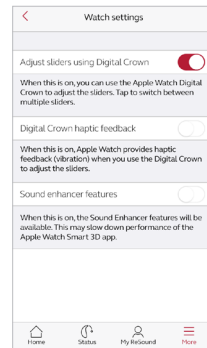

Enable “complications”

- You can also use ReSound Smart 3D app ‘complications’. These are small control icons shown on the main Apple Watch screen. They will show your current program, and will take you directly to the app with a simple tap.
- You can enable complications by customizing the Apple Watch face. This is initiated via a long press on the Watch face and by choosing “customize”.

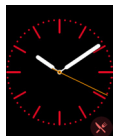

- The small square areas are complications. Select one complication and use the slider to navigate to the ReSound complication icon.

You can also use the Apple Watch digital crown for volume adjustments when on the Home screen. In streamer programs, tap the streamer bar to adjust that with the digital crown.

Home screen

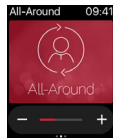

The Home screen shows you the current program.

Programs and Favorites

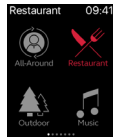

Program overview

Swipe right from the Home screen to see program overview. Tap one of the program icons to choose a program. Scroll down to choose between hearing aid programs, streamer programs and your own Favorites. You can create new Favorites in the ReSound Smart 3D app on the iPhone.

Volume control

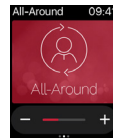

Hearing aid volume control

Tap the + or icons to increase or decrease the volume of the hearing aid.

To mute/unmute the hearing aids, force touch on the screen.

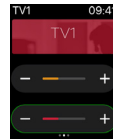

Streamer volume control

When a streamer program is selected you can adjust the streaming volume separately with the orange volume slider. You can also mute/unmute the streaming volume by force touch.

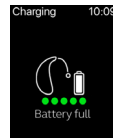

Monitor battery status

You can monitor the battery status of your rechargeable hearing aids, also while charging.

Quick buttons and Sound Enhancer

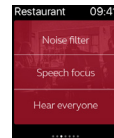

Swipe left from the Home screen to find Quick buttons and Sound Enhancer.

Adjust all Sound Enhancer features by tapping the + and – icons. Use force touch to reset to fitted settings.

Comfort in Noise

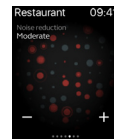

Speech Focus

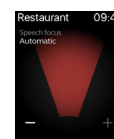

Comfort in Wind

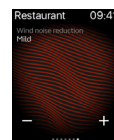

Bass and treble

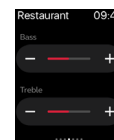

Stream sound to your Android phone

Stream from your Android phone to your ReSound Smart Hearing aids using the ReSound Phone Clip+

When paired and connected to the ReSound Phone Clip+, your Smart Hearing aids can stream stereo sound from your Android phone.

Simply open a media player on your phone and press play. Your hearing aids will switch to the streaming program and after a few seconds you will hear audio.

Pairing your ReSound Phone Clip+ with your Android phone

- Go to the phone settings and make sure that Bluetooth is turned on
- Turn on the Phone Clip+, remove the silver cap, and locate the small blue Bluetooth pairing button
- Tap the button once to activate Bluetooth pairing mode. The LED indicator will turn blue and the Phone Clip+ will be in Bluetooth pairing mode for 2 minutes
- After a few seconds, select **Hearing Aid Phone** from the list of available Bluetooth devices on your phone
- If asked for a passcode, enter **0000** (four zeros) and then select **Headset**

Pairing your ReSound Phone Clip+ to your hearing aids

- Open the hearing aid battery door or insert rechargeable hearing aids in the charger
- Turn on the Phone Clip+, remove the silver cap, and locate the small white hearing aid pairing button
- Tap the button to activate the hearing aid pairing mode. The LED will blink yellow every 2 seconds and the Phone Clip+ will be in pairing mode for 20 seconds
- Close the battery doors on your hearing aids or remove the rechargeable hearing aids from the charger

For further information about the ReSound Phone Clip+ refer to the user guide, instruction video or visit www.resound.com/wirelessconnectivity

Try more apps from ReSound

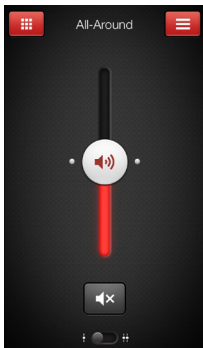

ReSound Smart™



The ReSound Smart app puts basic controls and more advanced features at your fingertips so you can personalize your hearing experience.

The ReSound Smart app* is the first hearing aid app with a direct connection between your hearing aids and the mobile phone.

resound.com/smartapp



*Dependent on local availability.

The ReSound Smart app is compatible with the following ReSound Smart Hearing aids:

- ReSound LiNX²™
- ReSound LiNX™
- ReSound LiNX TS
- ReSound ENZO²™
- ReSound ENZO™
- ReSound Up Smart™



Try more apps from ReSound

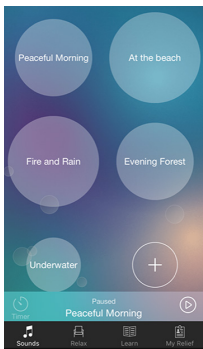

ReSound Relief™



If you suffer from tinnitus, you might like to try the ReSound Relief app*.

It combines relaxing sounds and exercises that aim to help you find relief from tinnitus.

resound.com/reliefapp

*Dependent on local availability.

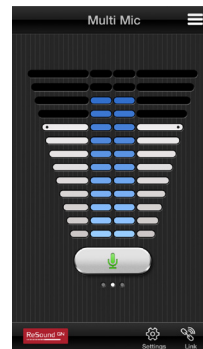

ReSound Control™



Don't forget to download the ReSound Control app* if you are using wireless ReSound hearing aids with a Phone Clip+.

The app enables you to change programs and adjust volume.

resound.com/control

*Dependent on local availability.

Please refer to resound.com/smart3Dapp for more information and a user guide for the ReSound Smart 3D™ app.

Worldwide

Headquarters

GN Hearing A/S
Lautrupbjerg 7
DK-2750 Ballerup,
Denmark
Tel.: +45 45 75 11 11
resound.com

CVR no. 55082715

United Kingdom

GN Hearing Ltd.
Kirtlington Business Centre
Portway
Kirtlington
Oxon OX5 3JA
Tel.: +44 1869 352 800
resound.com

Australia

GN Hearing Australia Pty. Ltd.
Gate C, 19-25 Khartoum Road
Macquarie Technology Park
Macquarie Park NSW 2113
Tel.: 1800 658 955
resound.com/en-au

New Zealand

GN Hearing New Zealand
Limited.
Ground Floor,
North Entrance
4 Fred Thomas Drive
Takapuna
Auckland, 0622
Tel.: 0800 900 126
resound.com/en-au

Singapore

GN Hearing Pte. Ltd.
2 Kallang Avenue
#07-19 CT HUB
Singapore – 339407
Tel: +65 6320 9388
resound.com

© 2017 GN Hearing A/S. All rights reserved. ReSound is a trademark of GN Hearing A/S. Apple, the Apple logo, iPhone, iPad Pro, iPad Air, iPad mini, iPad, iPod touch, Apple Watch, FaceTime, watchOS and CarPlay are trademarks of Apple Inc., registered in the U.S. and other countries. App Store is a service mark of Apple Inc., registered in the U.S. and other countries. Android, Google Play and the Google Play logo are trademarks of Google Inc. The Bluetooth word mark and logos are registered trademarks owned by the Bluetooth SIG, Inc.

